



Your Pathway to PREPAREDNESS

www.embrevard.com

EVACUATION ROUTES AND ZONES

SPACE COAST EMERGENCY INFORMATION

EVACUATION ROUTES AND ZONES

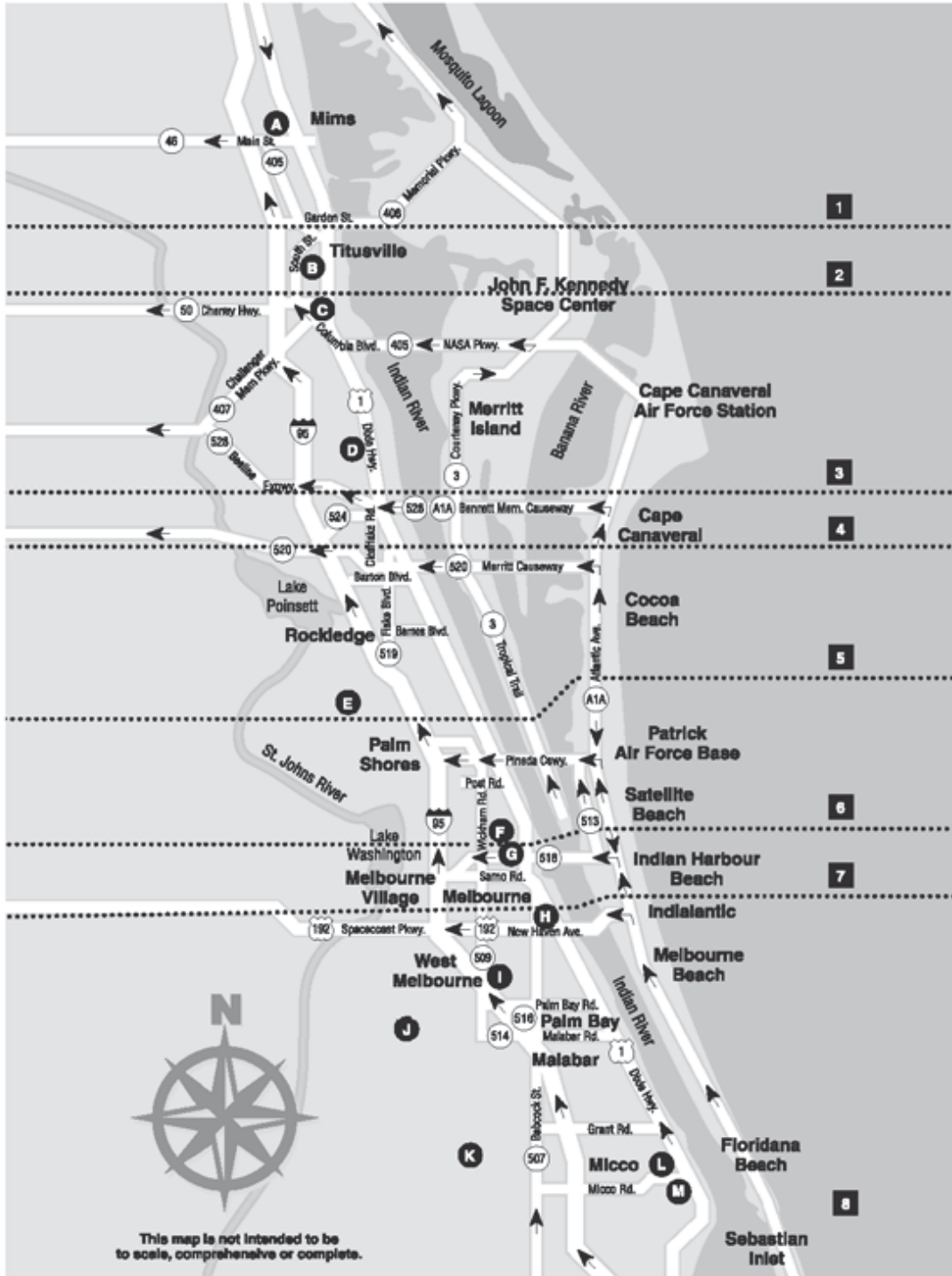

EVACUATION ROUTES AND SHELTERS

1. Residents north of Garden St. to north county line: evacuate west on SR 46 to I-95, or continue west on SR 46, or shelter at Mims Elementary School off of US 1.
2. Residents from Garden St. to SR 50: evacuate to I-95, or west on SR 50, or shelter at Apollo Elementary School.
3. Residents of North Merritt Island, Port St. John & South Titusville: evacuate west on SR 405 to SR 50 west, or I-95, or shelter at Imperial Estates Elementary School on Imperial Estates Ln in Titusville.
4. Merritt Island, the beachside & mainland residents north of SR 520: evacuate west on SR 528 (Beachline), or shelter at Walter Butler Community Center, Cocoa on US Hwy 1.
5. Residents north of Patrick AFB and Macaw Lane on Merritt Island: evacuate west on SR 520, or shelter at Manatee Elementary School. Mainland residents south of SR 520: use Eyster Blvd, Barnes Blvd, or Viera Blvd west, or Fiske Blvd south to evacuate to I-95, or shelter at Manatee Elementary School.
6. Residents south of Patrick AFB to north limits of Indian Harbour Beach & south of Macaw Lane on Merritt Island: evacuate west on Pineda Cswy to I-95, or shelter at Sherwood Elementary near Wickham and Post Rds. Mainland residents south of Wickham Rd and north of Aurora Rd: evacuate west to I-95, or shelter at Sherwood Elementary on Post Rd.
7. Residents from the north Indian Harbour Beach limits to the Indianalantic north limits: evacuate west on SR 518 to I-95. Mainland residents from Aurora Rd. to US-192: evacuate west or shelter at Eau Gallie High School.
8. Residents from the north limits of Indianalantic, or mainland south of US-192, to the south county line: evacuate west on US-192 or west on Palm Bay Rd or Malabar Rd to I-95. Residents of Melbourne may shelter at Melbourne High School or at Meadowlane Intermediate Elementary. Residents of West Melbourne and Melbourne Village may also shelter at Meadowlane Intermediate Elementary. Residents of Palm Bay and surrounding areas may shelter at Bayside High School or Heritage High School.

NOTE: Residents in the Barefoot Bay and south county area who do not have transportation may report to the Barefoot Bay Community Center Bldg A for transportation to Bayside High School or at South Mainland Community Center for sheltering.

PRIMARY EVACUATION SHELTERS

- A. MIMS ELEMENTARY** – 2582 US Highway 1, Mims
- B. APOLLO ELEMENTARY** – 3085 Knox McRae Dr., Titusville
- C. IMPERIAL ESTATES ELEMENTARY** – 900 Imperial Estates Ln., Titusville
- D. WALTER BUTLER COMMUNITY CENTER**- 4201 US Hwy 1, Cocoa
- E. MANATEE ELEMENTARY** – 3425 Viera Blvd., Viera
- F. SHERWOOD ELEMENTARY** – 2541 Post Road, Melbourne
- G. EAU GALLIE HIGH SCHOOL** – 1400 Commodore Blvd., Melbourne
- H. MELBOURNE HIGH SCHOOL** – 74 Bulldog Blvd., Melbourne
- I. MEADOWLANE INTERMEDIATE ELEMENTARY** –
2700 Wingate Blvd., West Melbourne
- J. HERITAGE HIGH SCHOOL** – 2351 Malabar Rd., Palm Bay
- K. BAYSIDE HIGH SCHOOL** – 1901 DeGroodt Rd., S.W. Palm Bay
- L. BAREFOOT BAY COMMUNITY CENTER** – Bldg A, Barefoot Blvd.
(Not a Shelter – See NOTE under Evacuation & Shelter Routes)
- M. SOUTH MAINLAND COMMUNITY CENTER** – 3700 Allen Ave., Micco

Shelter openings are incident-specific. Never go to a shelter unless local officials have announced it is open.

If ordered, evacuate immediately and follow these instructions:

- Stay as calm as possible, and take your Disaster Supply Kit.
- Wear protective clothing and sturdy shoes.
- Turn OFF lights and appliances, but leave your refrigerator and freezer on.
- Lock your home.
- Stay informed through battery-powered radios.
- Use travel routes specified by local authorities.
- If you need transportation, go with a neighbor, friend or relative, or ask Law Enforcement for assistance. By planning ahead, you can register via the Special Needs Registry.

TRANSPORTATION TO A SHELTER

Through the County's Special Needs Program, residents can register for transportation assistance to and from an evacuation shelter for individuals who do not have the ability to drive. Citizen registration must be updated annually.

PREPARING TO GO TO A SHELTER

Citizens going to a shelter need to take their own supplies. Some of these supplies may also be found in your disaster supply kit.

- **ALL REQUIRED MEDICATIONS AND MEDICAL SUPPORT EQUIPMENT:**
 - Wheelchair/ walker, oxygen, dressings, feeding and suction equipment, diapers, etc.
 - Any specific medication or care instructions (2-week supply)
 - Name and phone number of physician/home health care agency/ hospital where you receive care
- **DIETARY NEEDS:**

If you are on a special diet, you need to bring a 3-day supply of nonperishable food, per person.
- **FOOD AND WATER/ LIQUIDS:**

Snacks, juice, sports drinks, water, fruits, crackers (3-day supply)
- **SLEEPING GEAR:**

Bring your own pillows, sheets, blankets, portable cot or air mattress, chaise lounge, folding chairs, or sleeping bags for each person.
Evacuation shelters tend to be cold so bring something to keep warm.
COTS OR BEDS ARE NOT PROVIDED AT THE SHELTER.
- **IMPORTANT PAPERS:**

Wills, deeds, licenses, insurance policies, home inventory, doctor's orders, Do Not Resuscitate order, Living Will, etc.
- **IDENTIFICATION:**

With photo and current address, and medical identification card
- **CASH:**

Check cashing / credit card services may not be available for several days after the storm. BUT: Don't bring too much! There will be no place to secure money or valuables at the evacuation shelter.
- **COMFORT ITEMS:**

Small games, cards, books, magazines, etc.
- **PERSONAL HYGIENE ITEMS:**

Toothbrush, toothpaste, deodorant, towels, brush/comb, dentures, glasses, eye drops, diapers, etc.
- **EXTRA CLOTHING:**

A 3-day supply of comfortable clothing with extra sets of underwear and socks.

MOBILE OR MANUFACTURED HOMES

These homes are not safe during hurricanes. Hurricanes produce destructive winds that can severely damage or destroy these homes. All residents of mobile and manufactured homes are required to evacuate when a hurricane threatens. When the Evacuation Order is given, leave the area and seek safe shelter!

SPECIAL NEEDS

The Special Needs directory is a confidential listing of Brevard County residents, who need assistance due to their medical or physical condition. Residents who meet the Special Needs criteria and have **no other alternative for safe sheltering** should register annually with Emergency Management. Applications can be requested from:

- Home Health Care or Hospice Agencies
- Medical Supply Companies
- Brevard County Emergency Management

Online at www.embrevard.com or by calling 321-637-6670.

For Special Needs Clients with Pets

Please ensure you complete the pet section on the Special Needs Application. Brevard County Sheriff's Office Animal Services Unit will assist you with sheltering your pet at one of the county animal shelters, while you are at your special needs shelter.

When it is time to go to the shelter, you will receive a call notifying you that you will be picked up and an approximate time. You will need to have all of your items ready as well as your pet and their items. Once the emergency has passed and you are returned to your home, your pet will be returned to you.

PERSONS WITH DISABILITIES, BARRIERS OR IMPAIRMENTS

For those that have disabilities, impairments or other access and/or functional needs, disasters can present a real challenge. By evaluating your own personal needs and making an emergency plan, you can be better prepared for any situation. Here are some things to consider when planning for your unique needs:

- Stock a basic disaster supply kit.
- **Inventory what you use every day to live independently.** Identify the essential items you will need to be able to survive for three days, or longer if people cannot get to you or you are in a shelter.
- **Stock these custom essentials in your kit.** For example, your kit may contain items such as durable medical equipment, assistive technology, food for special diets, prescription medicines, diabetic supplies, hearing aids and batteries, a TTY, manual wheelchair, and/or supplies for a service animal. Prepare for the loss of electrical power at an evacuation shelter.
- Make arrangements for transportation assistance if needed – call Brevard County Emergency Management at 321-637-6670.
- **Ensure that you have methods for communicating your impairments and needs to others.**

Remember: Being ready is the key to maintaining your independence.

PET OWNERS

Having a plan is important and that plan should include your pets. Be sure your plan includes a backup option in case you can't care for your animals. Pet owners are strongly advised to make prior arrangements for sheltering your pet during emergencies. To find information on hotels that will accept pets, visit:

Pets Welcome - <http://www.petswelcome.com>

Dog Friendly - <http://www.dogfriendly.com>

Bring Fido - <http://www.bringfido.com>

It is strongly encouraged that you make a list of potential hotels ahead of time and begin calling immediately when a storm threatens.

Pets are not allowed in public shelters administered by the American Red Cross. Pet Friendly Shelters will be available for residents to shelter with and care for their pets at the following locations:

PORT ST JOHN COMMUNITY CENTER – 6650 Corto Road
VIERA REGIONAL PARK – 2300 Judge Fran Jamieson Way
WICKHAM PARK COMMUNITY CENTER – 2815 Leisure Way
PALM BAY REGIONAL PARK – 1951 NW Malabar Rd

These shelters will be open to people and pets in mandatory evacuation areas only. Shelter openings are incident-specific. Never go to a shelter unless local officials have announced it is open.

You will need:

- | | |
|--|------------------------------|
| ■ Current rabies vaccination certificate | ■ Leash and collar |
| ■ County animal license tags | ■ Crate or cage |
| ■ Pet food | ■ Cleaning supplies |
| ■ Medications | ■ Comfort items for your pet |

If you are not in a mandatory evacuation area and decide to leave, you must make arrangements for your pet to go with you. Pets should not be left behind unattended. The Melbourne Greyhound Park will NOT be used as a pet evacuation shelter.

For emergencies countywide, call Brevard County Sheriff's Office Animal Services Unit at 321-633-2024. For more information, visit: www.brevardsheriff.com/home/commands-services/operational-services/animal-services/

Disaster Preparedness for Large Animals or Livestock visit:

- www.brevardcounty.us/EmergencyManagement/Preparedness/Pets

Remember: What's best for you is usually what's best for your animals.

STAY INFORMED

During a disaster, the home page for **Brevard County Emergency Management** will display all the latest information related to the incident such as open shelters, evacuation orders, government and school closures, etc.

www.embrevard.com

If you do not have access to the internet, call **211** for this information.

SOCIAL MEDIA

- Follow @BrevardEOC on  Twitter
- Like “Brevard County Emergency Management” on  Facebook.

TEXT ALERTS

To receive text message updates on your cell phone, text **Follow BrevardEOC** to **40404** (normal text messaging rates apply).

ALERT NOTIFICATIONS

Residents of Brevard can be notified about emergencies in their area through a call notification system. However, automated call notifications go only to landline telephones with listed numbers. If you have an unlisted number, or rely on a cell phone as your main telephone, you can register your number under “Alert Sign-up” at www.embrevard.com.

NOAA WEATHER WARNINGS

The best way to receive warnings for hazardous weather is to have a NOAA Weather Radio. The NOAA Weather Radio is the National Weather Service’s direct link to the public. They broadcast continuous weather information 24-hours a day. The broadcasts include severe weather watches and warnings, as well as routine forecasts, current conditions, and climatology. An additional feature, the Specific Area Message Encoder has been added so that weather radios can be programmed to warn only for specific locations.

The primary frequency for Weather Alert Radios in Brevard County is **162.550MHz** and the SAME (FIPS) code is **012009**

2-1-1 Brevard

Provides information & assistance in times of emotional, financial & community crisis. 2-1-1 is a simple, easy-to-remember number to call when you want to find or give help in Brevard County. Trained 2-1-1 counselors are available around the clock to help people who:

- Are seeking information about or referral to local governmental, health or social services
- Want to talk to someone about grief, relationship issues, personal crisis, family concerns, etc.
- Are depressed and/or considering suicide
- Are interested in volunteering their time or donating money or items to local organizations

**For emergency info text messages
text "Follow BrevardEOC" to 40404**



"Like" on Facebook
www.facebook.com/BrevardEOC



Follow on Twitter
[@BrevardEOC](https://twitter.com/BrevardEOC)

**Help us build a culture of preparedness
in Brevard County**

Make a Plan

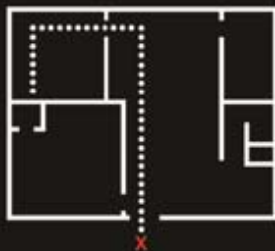

Build a Kit



Stay Informed



Call 2-1-1 for citizen information

Brevard County Emergency Management
1746 Cedar Street
Rockledge, FL 32955

321-637-6670

www.embrevard.com



Revised 2013